

PS200 Series

Automatic Bump Testing and Calibration

To complement the Personal Surveyor product line, GMI has developed a compact, robust and easy to use Auto Bump & Calibration Station that can provide full bump and calibration options. Data transfer is facilitated using a USB memory stick with Standalone software that is simple to set up and customise based on end users' specifications. Standalone, PC, and ethernet versions are available.

Standalone

By adding the Auto Bump & Calibration Station to your PS200 package, data can be easily retrieved using specific software in a user-friendly time logged format. This gives you the ability to create and print your personalized calibration certificate.

PC

Allows easy configuration (bump test or calibration) of Auto Bump & Calibration Station and allows all results to be automatically stored to a database on the PC. The stored results can be easily viewed and calibration certificates produced. The history of all results can be easily viewed and reports of instruments can be easily compiled.



Ethernet

Same as PC except multiple units can be connected to a network allowing one PC to control and receive data.

Datalogging

Datalogging is a standard feature of all PS200 Series instruments and the internal memory can hold up to 180 bump test and session logs, 8 calibration logs and 24hrs of timed logs at 1 log per minute.

Simple data extraction from instrument to PC using USB cable supplied. Upgrade your package to include PC datalogging software.

AUTO BUMP & CALIBRATION STATION TECHNICAL SPECIFICATION

| | |
|-------------------------------|--|
| Size: | 7.9" x 5.5" x 5.3" (200 x 140 x 135mm) |
| Weight: | 43oz (1.2kg) |
| Interfaces: | Standalone /USB /Ethernet |
| LED Indicators: | Power (Green) / Testing (Yellow) / Pass (Green) / Fail (Red) |
| Testing Time: | Bump Test 60 secs Calibration Test 90 secs |
| Data Storage: | >6000 Bump & Calibration results |
| Power Supply: | 12V dc, 2A |
| Operating Temperature: | 14°F to 104°F (-10°C to 40°C) |
| Gas Ports: | 3 (Air, Combi Gas & Exhaust) Contact Heath for other combinations |

SENSOR SPECIFICATIONS

| GAS | RANGE | INCREMENTS | SENSOR TYPE |
|------------------|------------|------------|-----------------|
| LEL | 0-100% LEL | 1% LEL | Catalytic Bead |
| O ₂ | 0-25% | 0.1% | Electrochemical |
| CO | 0-1000 ppm | 1 ppm | Electrochemical |
| H ₂ S | 0-100 ppm | 1 ppm | Electrochemical |

PS200 Series

Simple User Maintenance

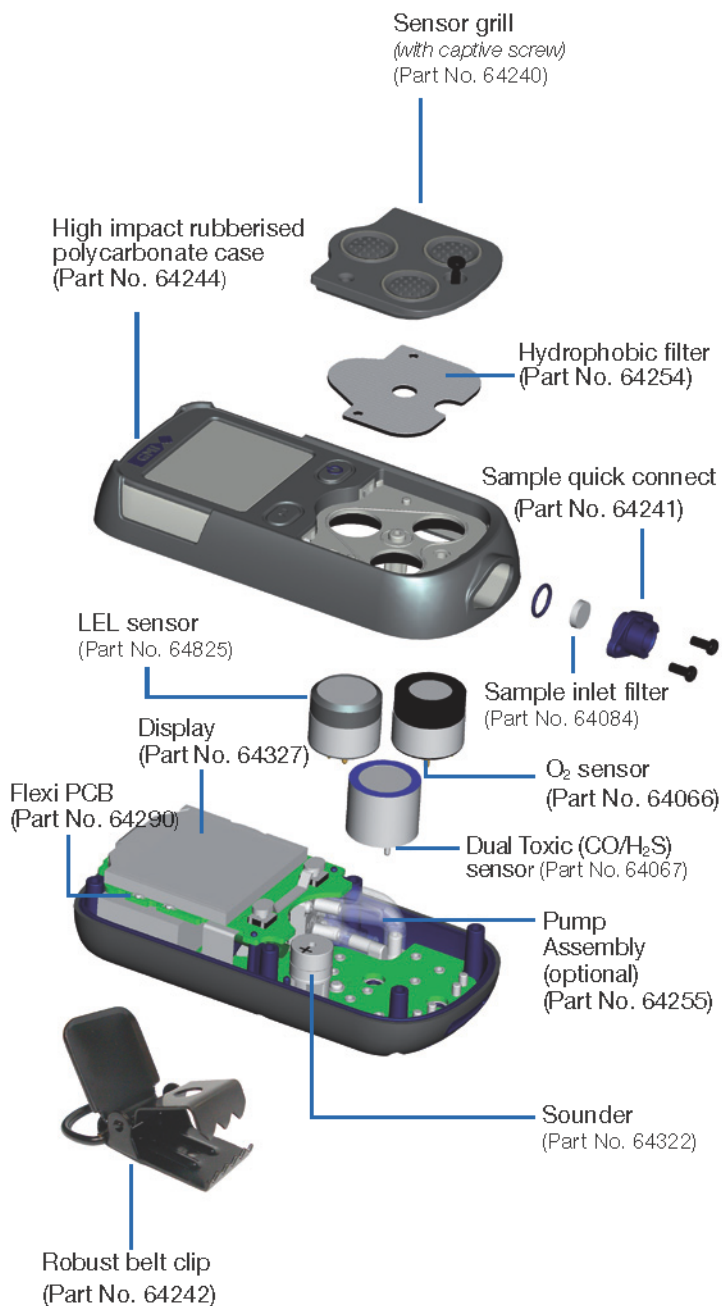

ORDERING INFORMATION AND ACCESSORIES

Accessories supplied with the instrument

| | |
|-------|--|
| 64260 | USB Charging / Comms Cable |
| 64247 | Universal Power Plug (Mains – USB) |
| 64190 | User CD-ROM (Incl. Handbook) |
| 64172 | Quick Operating Instructions |
| 64118 | 3m. PVC sample line with Quick Connector (pumped only) |

RECOMMENDED SPARE PARTS

| | |
|--------|---------------------------------------|
| 64254 | Hydrophobic Filter |
| 64084 | Sample Inlet Filter |
| 64825C | LEL sensor |
| 64066 | O ₂ sensor |
| 64067 | Dual Toxic CO/H ₂ S Sensor |
| 64176 | CO sensor |
| 64128 | H ₂ S sensor |
| 64255 | Pump Assembly |

ADDITIONAL ACCESSORIES

| | |
|-------|--|
| 64303 | Rubber Boot (Color options:- black, grey, yellow, red, orange, blue, green) |
| 66123 | Hand Aspirator |
| 66478 | Hand Aspirator (c/w 10 ft. tubing) |
| 66112 | Sample Line Extender |
| 66485 | In-Line Hydrophobic Filter Assy |
| 66545 | Ball Float |
| 64100 | Rugged Carry Case |

Charging Accessories

| | |
|-------|---|
| 64248 | In-Vehicle Charging Adaptor (12V/24V – USB) |
| 64138 | 5 Way Multi-Charger |

Automatic Bump & Calibration

| | |
|--------|--|
| 64052 | Auto Bump & Calibration Station (6mm. fittings & incl. PSU and USB stick with Standalone software) |
| 64052Q | Auto Bump & Calibration Station (1/4 in. fittings & incl. PSU and USB stick with Standalone software) |
| 99553 | flexiCal Plus software for PC |
| 99118 | Demand Flow Regulator |
| 64265 | Tubing with 6mm Push Fit Connector |

Manual Bump & Field Calibration Kit

| | |
|-------|---|
| 64051 | Manual Bump Kit (no power required) (c/w Combi Test Gas 99146, Direct Flow Regulator, tubing & sample line connector) |
|-------|---|

Gas Kits for Auto Bump & Calibration Station

| | |
|--------|---|
| 99146 | Combi Test Gas Cylinder (2.5% CH ₄ , 500ppm CO, 50ppm H ₂ S, 18% O ₂ , balance N ₂) |
| 64060 | Test Gas Kit (6mm fittings) (Combi Test Gas 99146, Demand Flow Regulator 99118 c/w 6mm tubing) |
| 64060Q | Test Gas Kit (1/4 in Fittings) (Combi Test Gas 99146, Demand Flow Regulator part no. 99118 c/w 1/4" tubing) |

Software

| | |
|-------|---|
| 64197 | Data downloading CD-ROM (c/w Handbook) |
| 64184 | Auto Bump & Calibration Station USB Flash Drive (c/w Handbook) |

Documentation

| | |
|-------|---|
| 64193 | Configuration & Field Calibration Handbook (CD-ROM) |
|-------|---|

Heath Consultants Incorporated operates under a continual product improvement program and reserves the right to make improvements and/or changes without prior notification.



Heath Consultants Incorporated
Houston, TX
713/844-1300 • Fax: 713/844-1309
1-800-HEATH-US
www.heathus.com